



Shanghai Lunsure Electronic
Technology Co.,Ltd
Tel:0086-21-37185008
Fax:0086-21-57152769

KBPC50005W THRU KBPC5010W

Features

- Mounting Hole For #8 Screw
- Plastic Case With Metal Bottom
- Any Mounting Position
- Surge Rating Of 400 Amps

50 Amp Single Phase Bridge Rectifier 50 to 1000 Volts

Maximum Ratings

- Operating Temperature: -50°C to +150°C
- Storage Temperature: -50°C to +150°C

Catalog Number	Device Marking	Maximum Reccurent Peak Reverse Voltage	Maximum RMS Voltage	Maximum DC Blocking Voltage
KBPC50005W		50V	35V	50V
KBPC5001W		100V	70V	100V
KBPC5002W		200V	140V	200V
KBPC5004W		400V	280V	400V
KBPC5006W		600V	420V	600V
KBPC5008W		800V	560V	800V
KBPC5010W		1000V	700V	1000V

Electrical Characteristics @ 25°C Unless Otherwise Specified

Average Forward Current	$I_{F(AV)}$	50.0A	$T_J = 55^\circ\text{C}$
Peak Forward Surge Current	I_{FSM}	400A	8.3ms, half sine
Maximum Forward Voltage Drop Per Element	V_F	1.2V	$I_{FM} = 25\text{A}$ per element; $T_J = 25^\circ\text{C}^*$
Maximum DC Reverse Current At Rated DC Blocking Voltage	I_R	10 μA 0.5mA	$T_J = 25^\circ\text{C}$ $T_J = 100^\circ\text{C}$

*Pulse test: Pulse width 300 μsec , Duty cycle 1%

KBPC35W

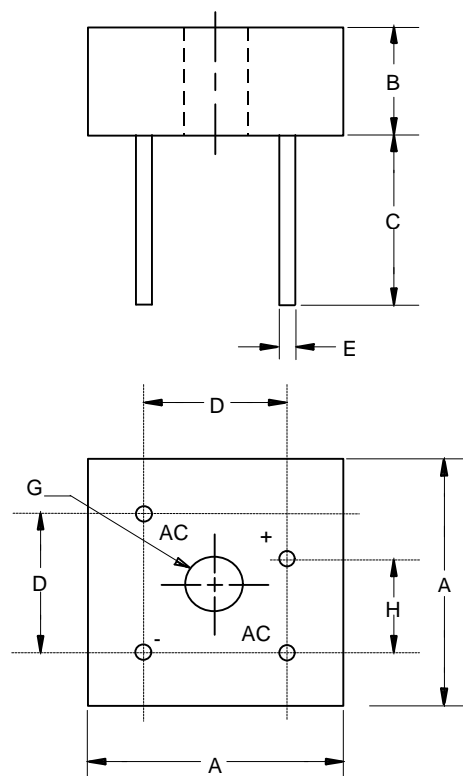

DIM	INCHES		MM		NOTE
	MIN	MAX	MIN	MAX	
A	---	1.140	---	29.00	
B	---	.452	---	11.50	
C	0.774	----	19.65	----	
D	.673	.752	17.1	19.10	
E	.048	.052	1.00	1.30	4PL/TF
G	.193	---	4.90	---	\emptyset
H	.429	.468	10.9	11.9	



KBPC50005W thru KBPC5010W

Figure 1
Typical Forward Characteristics

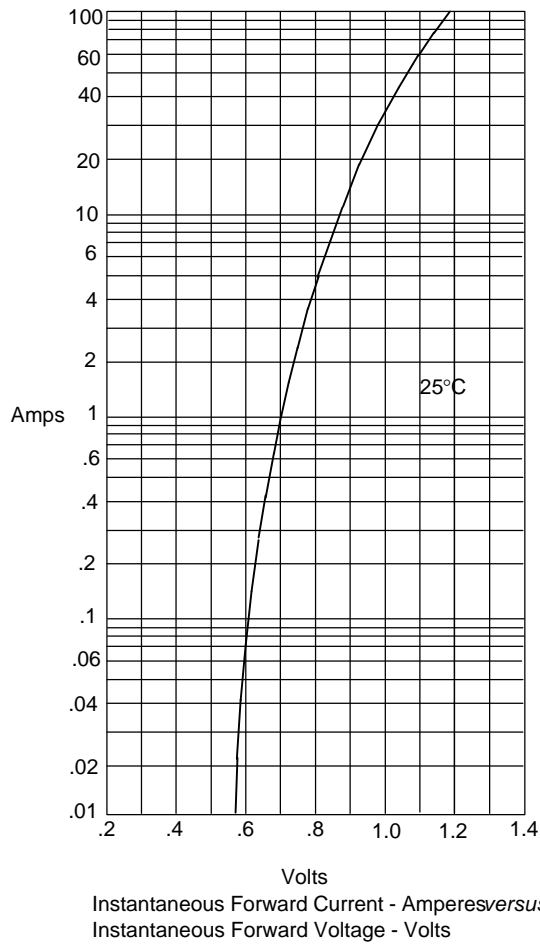

Figure 2
Typical Reverse Characteristics

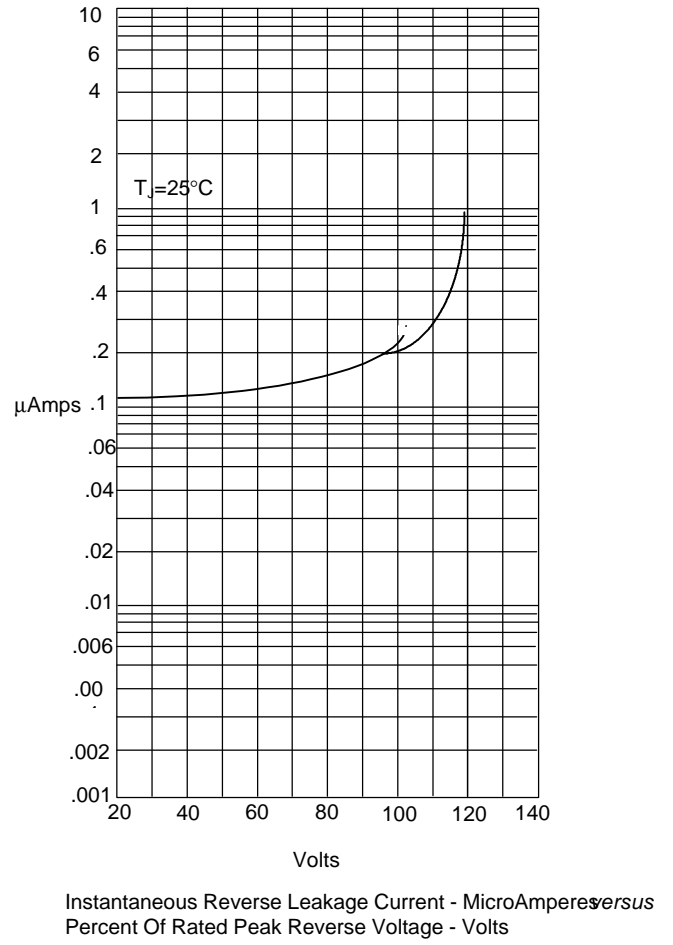

Figure 3
Forward Derating Curve

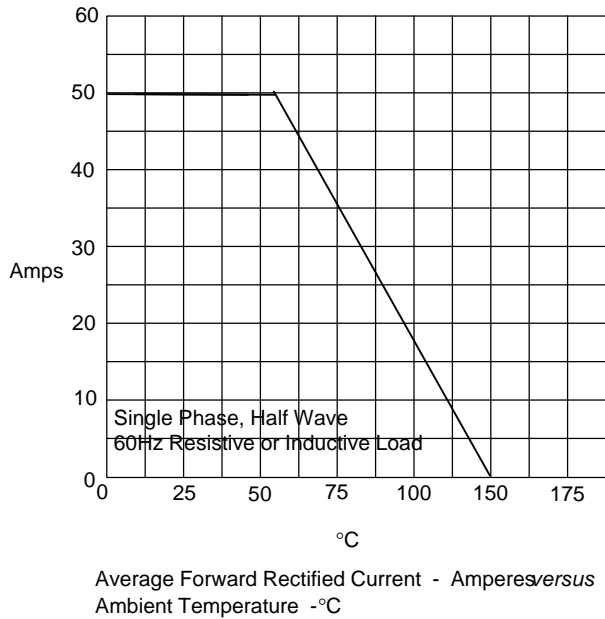

Figure 4
Peak Forward Surge Current

